



RECEIVED  
#3

2017 APR 11 AM 11:14

OFFICE OF THE CITY CLERK  
CITY OF CHICAGO  
ANNA VALENCIA

OFFICE OF THE  
CITY CLERK

**NOTICE OF INTENT FORM**

**1. Submit a complete and accurate description of the precinct you wish to restrict.**

The description of the precinct boundaries of the 35 Precinct of the 23 Ward of the City of Chicago in the County of Cook and the State of Illinois, as such precinct existed as of the last General Election, is as follows:

please see attached

**2. Please select the scope of restriction sought for the 35 Precinct of the 23 Ward:**

**A: Restricting Shared Housing Units and Vacation Rentals**

- Restrict all new or additional *shared housing units AND vacation rentals*.
- Restrict all new or additional *shared housing units*.
- Restrict all new or additional *vacation rentals*.

OR

**B: Restricting Shared Housing Units and Vacation Rentals that are NOT their owner's Primary Residence:**

- Restrict all new or additional *shared housing units AND vacation rentals* that **ARE NOT** their owner's or tenant's primary residence.
- Restrict all new or additional *shared housing units* that **ARE NOT** their owner's or tenant's primary residence
- Restrict all new or additional *vacation rentals* that **ARE NOT** their owner's or tenant's primary residence.

NORBERTO LAUREL      Norberto Laurel      4-11-17  
 Petitioner Name                      Signature                      Date







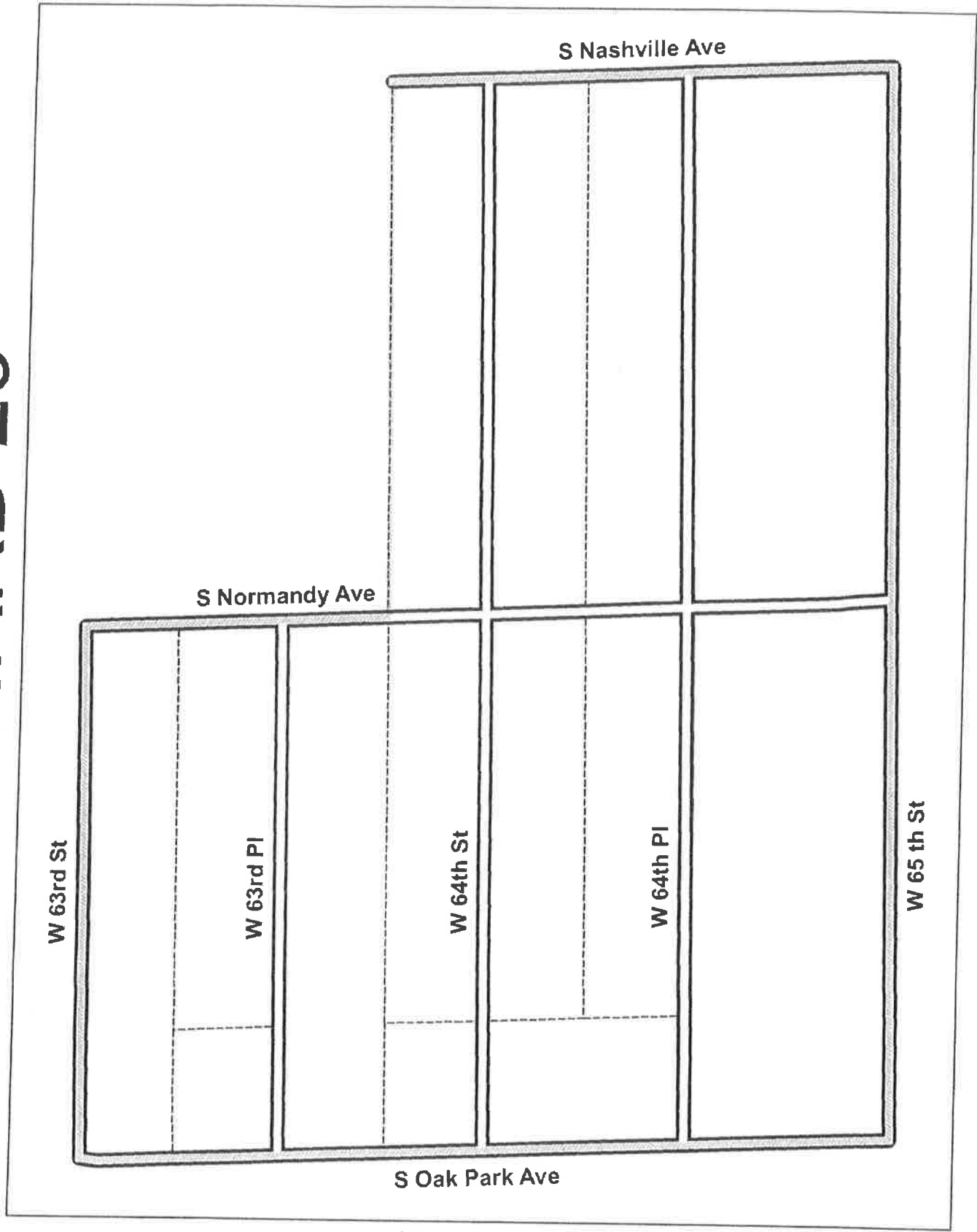

**PCT 35    WARD 23**

Beginning at the intersection of S. Oak Park Av. and W. 63<sup>rd</sup> St., thence east on W. 63<sup>rd</sup> St. to S. Normandy Av., thence south on S. Normandy Av. to the alley north of W. 64<sup>th</sup> St., thence east on the alley north of W. 64<sup>th</sup> St. to S. Nashville Av., thence south on S. Nashville Av. to W. 65<sup>th</sup> St., thence west on W. 65<sup>th</sup> St. to S. Oak Park Av., and north on S. Oak Park Av. to the place of beginning.

# PCT 35 WARD 23



## Legend

-  Precinct Boundary
-  Freeway
-  Major Street
-  Local Street
-  Service Drive
-  Ramp
-  Alley
-  Streams
-  Railroad

Board of Elections  
City of Chicago  
69 W Washington, Suite 600  
Chicago, IL 60602  
312-269-7900  
[www.chicagoelections.com](http://www.chicagoelections.com)

September 19, 2012

