



City of Chicago



O2017-8601

Office of the City Clerk

Document Tracking Sheet

Meeting Date:	12/13/2017
Sponsor(s):	Quinn (13)
Type:	Ordinance
Title:	Designation of 29th Precinct of 13th Ward as Restricted Residential Zone prohibiting additional shared housing units and vacation rentals
Committee(s) Assignment:	Committee on License and Consumer Protection

Licensing

ORDINANCE

WHEREAS, Chapter 4-17 of the Municipal Code of Chicago authorizes the establishment of Restricted Residential Zones pursuant to an opt-out process, which requires a petition to trigger an ordinance; and

WHEREAS, The requisite procedural requirements have been met; now, therefore,

BE IT ORDAINED BY THE CITY COUNCIL OF THE CITY OF CHICAGO:

SECTION 1. Pursuant to Sections 4-17-020 and 4-17-040 of the Municipal Code of Chicago ("Code"), the 29th Precinct of the 13th Ward, as described herein, is hereby designated as a Restricted Residential Zone within the meaning of Chapter 4-17 of the Code. All new or additional shared housing units and vacation rentals shall be prohibited within the boundaries of such 29th Precinct, with such boundaries beginning at the southeast intersection of the Belt Railway Company of Chicago railroad tracks and West 63rd Street, thence east on the south side of West 63rd Street to the west side of South Kilbourn Avenue, thence south on the west side of South Kilbourn Avenue to the south side of West 64th Street, thence east on the south side of West 64th Street to the west side of South Kenneth Avenue, thence south on the west side of South Kenneth Avenue to the north side of West Marquette Road, thence west on the north side of West Marquette Road to the Belt Railway Company of Chicago railroad tracks, and thence north on the Belt Railway Company of Chicago railroad tracks to the place of beginning.

SECTION 2. This ordinance shall take full force and effect upon its passage and publication, and shall remain in effect for four years following its effective date.



Marty Quinn
Alderman, 13th Ward

PCT 29 WARD 13

Beginning at the intersection of the Branch of C R.R. and W. 63rd St., thence east on W. 63rd St. to S. Kilbourn Av., thence south on S. Kilbourn Av. to W. 64th St., thence east on W. 64th St. to S. Kenneth Av., thence south on S. Kenneth Av. to W. 67th St., thence west on W. 67th St. to the Branch of C R.R., and thence north on the Branch of C R.R. to the place of beginning.

PCT 29 WARD 13

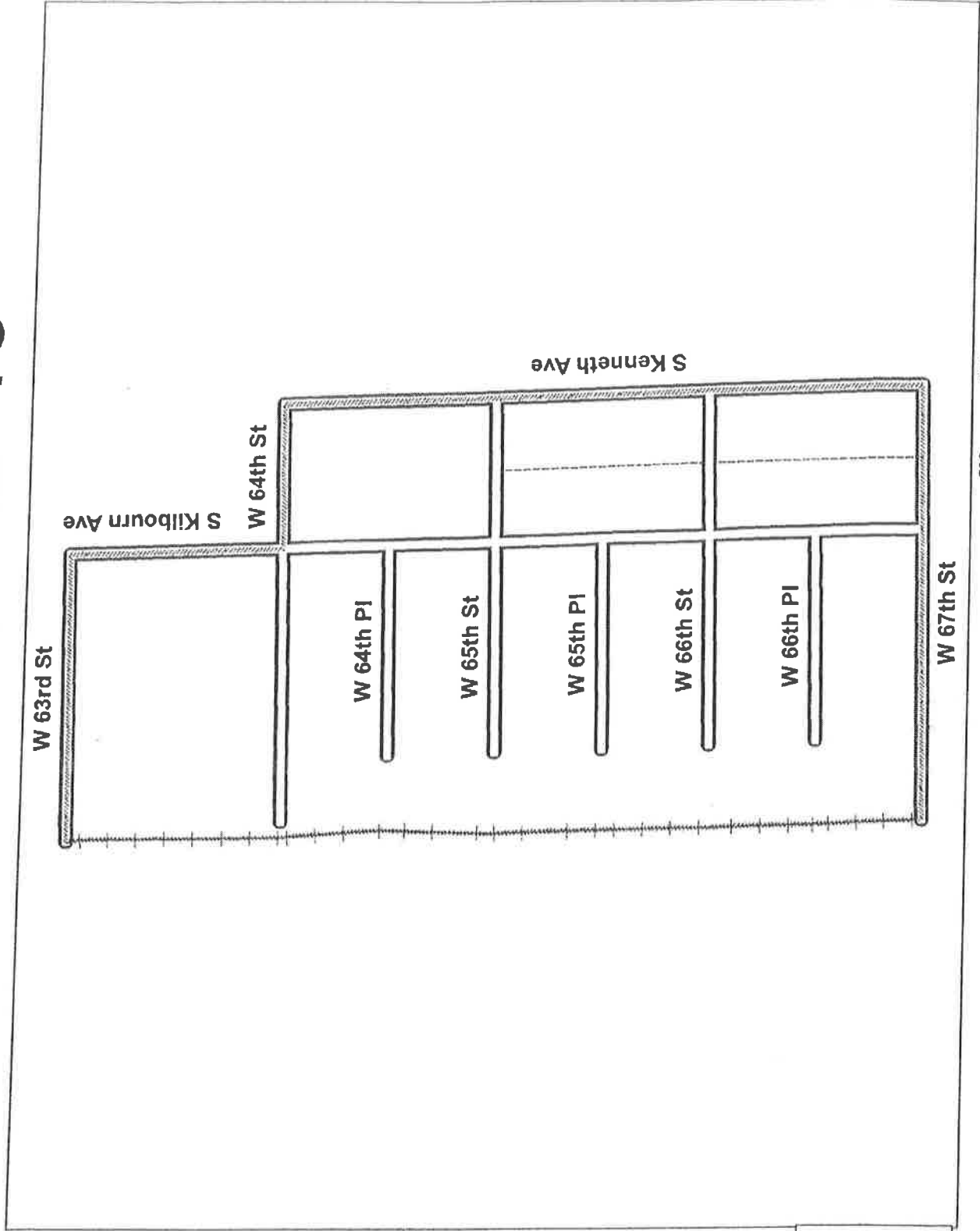

Legend

- Precinct Boundary
- Freeway
- Major Street
- Local Street
- Service Drive
- Ramp
- Alley
- Streams
- Railroad

Board of Elections
 City of Chicago
 69 W Washington, Suite 600
 Chicago, IL 60602
 312-269-7900
www.chicagoelections.com

September 19, 2012

